



BOSCH



Register your
new device on
MyBosch now and
get free benefits:
[bosch-home.com/
welcome](https://bosch-home.com/welcome)

Grain Mill

MUZ9GM1

[en] User manual

Grinding mill

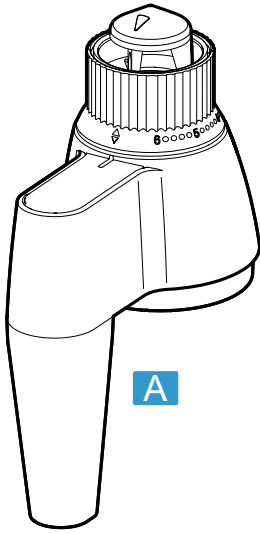

A

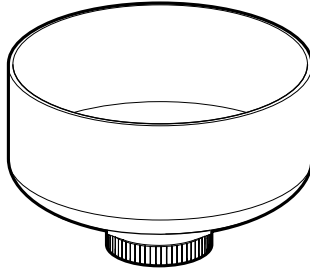

B

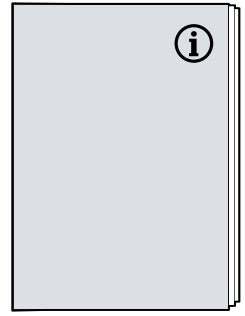

C

1

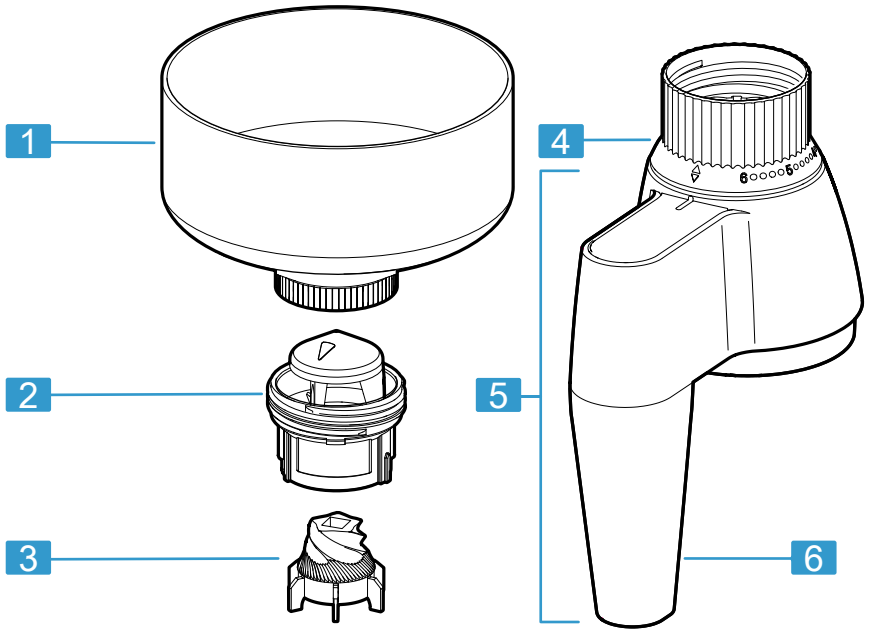

2

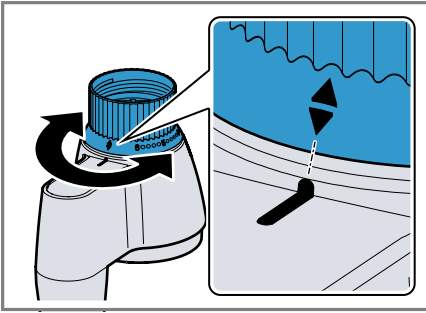

3

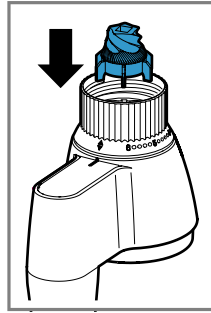

4

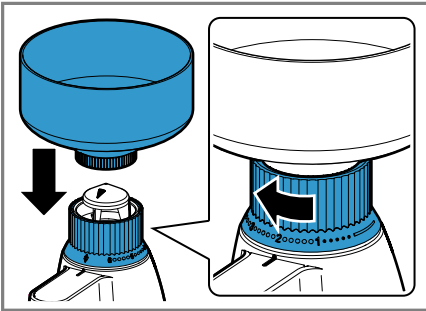
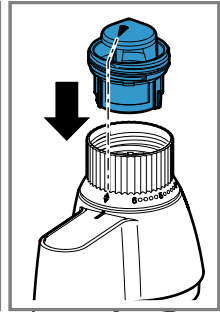

5

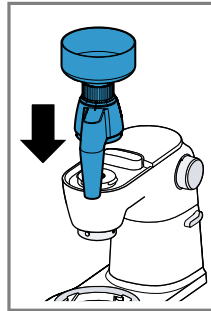

6

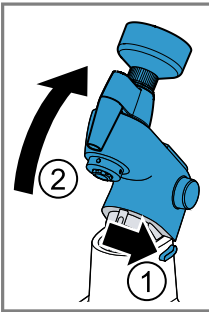
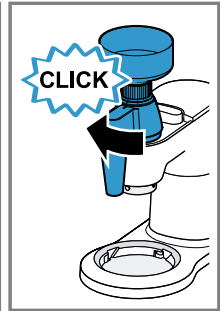

7

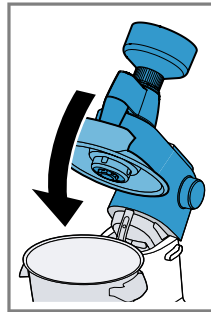
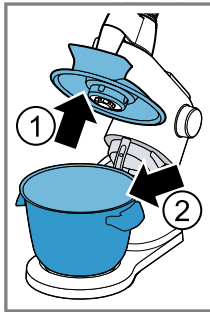

8

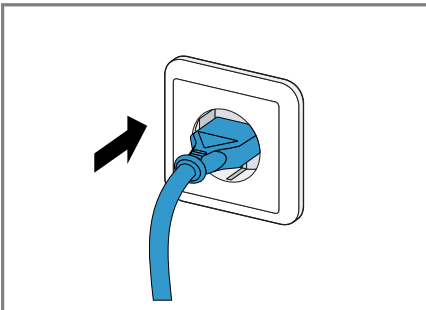
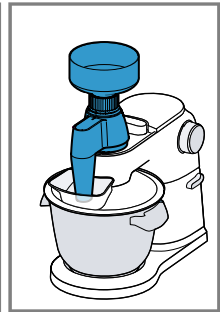

9

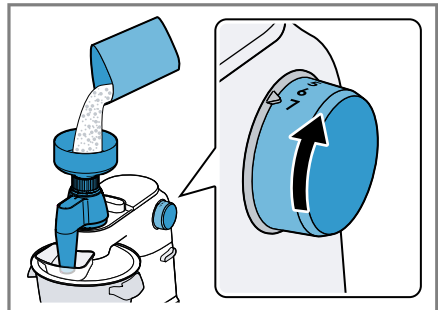

10

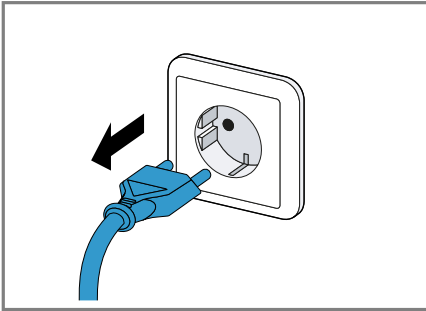

11

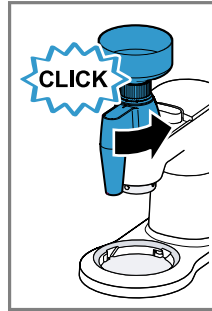

12

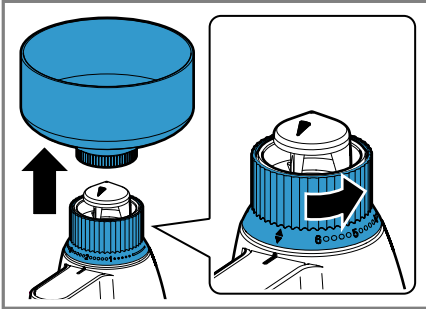
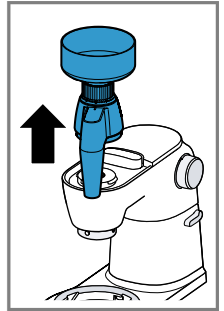



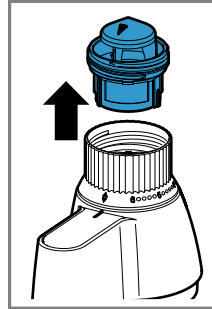

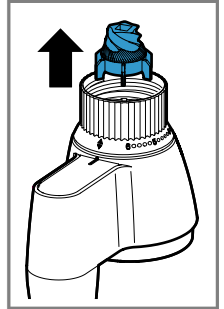

13



14



					
	✓	✓	✓	✓	✓
	✓	✗	✗	✗	✗

15

For further information, please refer to the Digital User Guide.



Table of contents

1 Safety	12
1.1 General information.....	12
1.2 Intended use.....	12
1.3 Safety instructions	12
2 Avoiding material damage.....	13
3 Unpacking and checking	13
3.1 Unpacking the accessories and parts	13
3.2 Scope of delivery.....	13
3.3 Cleaning the accessory be- fore using for the first time	13
4 Familiarising yourself with the accessories	13
4.1 Components.....	13
5 Before using the appliance	13
5.1 Assembling the accessory	14
5.2 Attaching the accessory to the base unit.....	14
6 Basic operation	14
6.1 Grinding grain.....	14
6.2 After using the appliance	14
6.3 Disassembling the access- ory.....	15
7 Cleaning and servicing	15
7.1 Dishwasher-safe compon- ents.....	15
7.2 Cleaning products.....	15
7.3 Overview of cleaning.....	15
8 Troubleshooting.....	16



1 Safety

Observe the following safety instructions.

1.1 General information

- Read this instruction manual carefully.
- Observe the instructions for the base unit.

1.2 Intended use

Only use the accessories:

- with a kitchen machine from the same series MUM9.
- With genuine parts and accessories.
- for grinding wheat, rye, buckwheat, husk-free barley, husk-free oats, millet, spelt and rice.

1.3 Safety instructions

Observe the following safety instructions.

WARNING – Risk of injury!

Rotating drives, tools or accessory parts may cause injury.

- ▶ Do not reach into the filling shaft.

Improper use may cause injuries.

- ▶ Never assemble the accessories on the base unit.
- ▶ Only attach and remove accessories once the drive has stopped and the appliance has been unplugged.
- ▶ Only use the accessories once fully assembled.
- ▶ The accessories should only be used in the intended operating position.

2 Avoiding material damage

ATTENTION!

Improper use may cause material damage.

- ▶ Do not insert objects into the filling shaft or housing, e.g. wooden spoons.
- ▶ Never use the appliance to grind corn, poppy seeds, soya beans or coffee beans.
- ▶ Never operate the appliance at no-load.

3 Unpacking and checking

Find out here what you need to note when unpacking the appliance.

3.1 Unpacking the accessories and parts

1. Take the accessories out of the packaging.
2. Take all other parts and the accompanying documents out of the packaging and place them to hand.
3. Remove any packaging material.
4. Remove any stickers or film.

3.2 Scope of delivery

After unpacking all parts, check for any damage in transit and completeness of the delivery.

→ Fig. 1

A Housing with setting ring

B Filling container

C Accompanying documents

3.3 Cleaning the accessory before using for the first time

1. Clean all parts that come into contact with food before using for the first time.
→ "Cleaning and servicing", Page 15
2. Put the cleaned and dried parts out ready for use.

4 Familiarising yourself with the accessories

4.1 Components

You can find an overview of the parts of your accessories here.

→ Fig. 2

1 Filling container

2 Grinding ring

3 Grinding cone

4 Setting ring

5 Housing with setting ring

6 Discharge chute

5 Before using the appliance

Prepare the base unit and the accessories for use.

5.1 Assembling the accessory

1. Turn the setting ring so that the markings on the setting ring and housing line up.
→ Fig. **3**
2. Place the grinding cone on the square shaft in the housing.
3. Insert the grinding ring and press down lightly.
→ Fig. **4**
Note: To insert the grinding ring properly, make sure that the arrow marked on the grinding ring points to the markings on the setting ring and housing.
4. Position the filling container and then turn the grinding ring clockwise into the grinding area marked on the setting ring.
→ Fig. **5**

5.2 Attaching the accessory to the base unit

Requirements

- The bowl is not inserted.
 - The bowl lid is not fitted.
 - The protective cover of the front drive is not fitted.
 - The power cable has the required length but is not yet inserted.
1. Place the accessory on the front drive of the food processor and secure by turning clockwise.
→ Fig. **6**
 2. Press the Release button and move the swivel arm up.
 3. Attach the cover with the filling shaft on the main drive and insert the bowl.
→ Fig. **7**
 4. Move the swivel arm down again.
→ Fig. **8**
 5. Insert the cover.

6 Basic operation

6.1 Grinding grain

1. Place the grain in the filling hole.

Notes

- You can set the grinding level by turning the setting ring before or even during the grinding process. For a coarser grinding level, turn the setting ring anti-clockwise. For a finer grinding level, turn the setting ring clockwise.
- Please note that the grain to be processed must be dry and without stones.
- Observe the maximum processing quantity of 750 g. The markings on the filling container are for guidance and relate to wheat.
- To prevent overloading the appliance, grind max. 2 kg in one grinding process. Afterwards, leave the appliance to cool down for at least one hour.

2. Insert the mains plug.
→ Fig. **9**
3. Select the maximum speed setting for processing.
→ Fig. **10**

6.2 After using the appliance

1. After using the appliance, switch it off with the rotary switch.
2. Pull out the mains plug.
→ Fig. **11**

3. Press the Release button and move the swivel arm up.
4. Remove the bowl.
→ Fig. **7**
5. Remove the cover with the filling shaft from the main drive.
6. Move the swivel arm back down, turn the accessory anticlockwise and remove.
→ Fig. **12**

6.3 Disassembling the accessory

1. Remove the filling container.
2. Turn the setting ring anticlockwise until the markings on the setting ring and housing line up.
→ Fig. **13**
3. Remove the grinding ring and the grinding cone.
→ Fig. **14**

7 Cleaning and servicing

7.1 Dishwasher-safe components

Find out here which components can be put in the dishwasher.

ATTENTION!

Some parts may be damaged if they are put in a dishwasher.

- ▶ Only put dishwasher-safe parts in the dishwasher.
- ▶ Only use programmes that do not heat the water above 60 °C.
- ▶ Do not wedge plastic parts in the dishwasher.

7.2 Cleaning products

Find out here what cleaning agents are suitable for your accessories.

ATTENTION!

Using unsuitable cleaning agents or incorrect cleaning may damage the accessories.

- ▶ Do not use cleaning agents containing alcohol or spirits.
- ▶ Do not use sharp, pointed or metal objects.
- ▶ Do not use abrasive cloths or cleaning agents.

7.3 Overview of cleaning

Clean the individual parts as indicated in the table.

→ Fig. **15**

8 Troubleshooting

You can rectify minor faults on your appliance yourself. Read the troubleshooting information before contacting our after-sales service. This will avoid unnecessary costs.

Fault	Cause and troubleshooting
The grain mill is not working.	<p>The grain mill is not assembled correctly.</p> <ul style="list-style-type: none"> ▶ Check whether the grain mill has been assembled correctly. → <i>"Assembling the accessory", Page 14</i>
The grinding result is not how you want.	<p>An installed predetermined breaking point protects the drive from damage. The agitator paddle on the underside of the housing will break at the predetermined breaking point if there are foreign objects in the grinder or if damp grain is ground.</p> <ul style="list-style-type: none"> ▶ To replace the agitator paddle, re-order from customer service quoting order number 10018359. <p>The setting ring is not set to the grinding level required.</p> <ul style="list-style-type: none"> ▶ Set the grinding level required by turning the setting ring. → <i>"Grinding grain", Page 14</i>



Thank you for buying a Bosch Home Appliance!

Register your new device on MyBosch now and profit directly from:

- **Expert tips & tricks for your appliance**
- **Warranty extension options**
- **Discounts for accessories & spare-parts**
- **Digital manual and all appliance data at hand**
- **Easy access to Bosch Home Appliances Service**

Free and easy registration – also on mobile phones:

www.bosch-home.com/welcome

BOSCH
HOME APPLIANCES
SERVICE

Looking for help? You'll find it here.

Expert advice for your Bosch home appliances, help with problems or a repair from Bosch experts.

Find out everything about the many ways Bosch can support you:

www.bosch-home.com/service

Contact data of all countries are listed in the attached service directory.

BSH Hausgeräte GmbH

Carl-Wery-Straße 34

81739 München, GERMANY

A Bosch Company

www.bosch-home.com

Valid within Great Britain:

Imported to Great Britain by

BSH Home Appliances Ltd.

Grand Union House

Old Wolverton Road

Wolverton, Milton Keynes

MK12 5PT

United Kingdom



8001155339 (010830)

de, en, fr, it, nl, da, no, sv, fi, es, pt, el, tr, pl, uk, ru, ar