

# KENWOOD

English

2 - 3

AX500 AT501 AT502

instructions

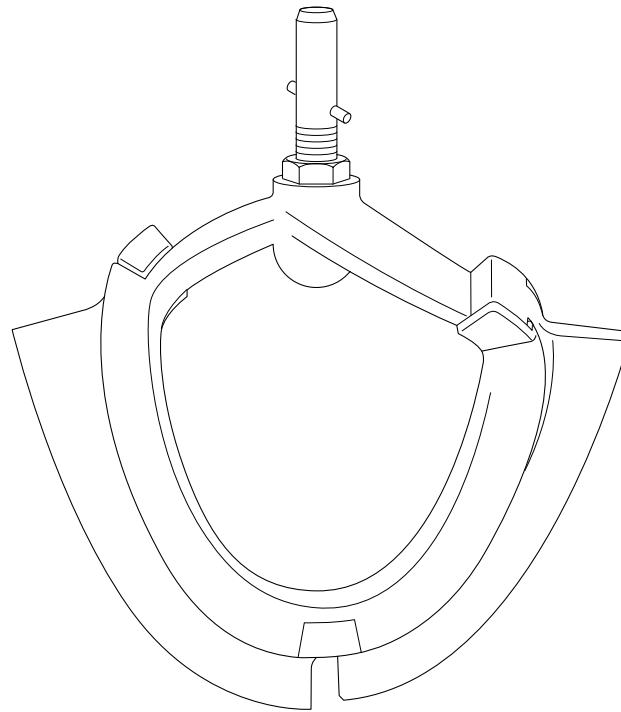

**Kenwood Ltd**

New Lane  
Havant  
Hampshire  
PO9 2NH

[kenwoodworld.com](http://kenwoodworld.com)



## English

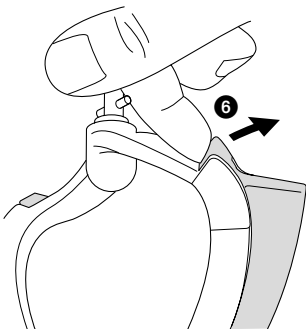
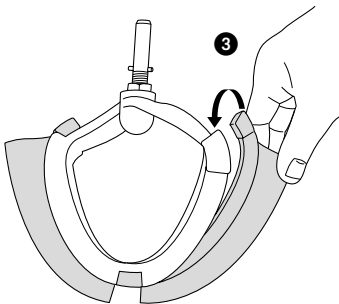
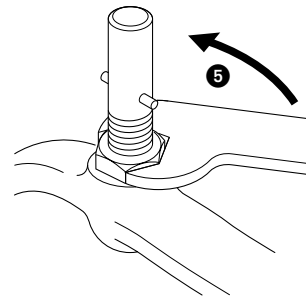
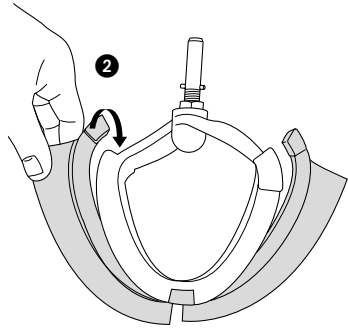
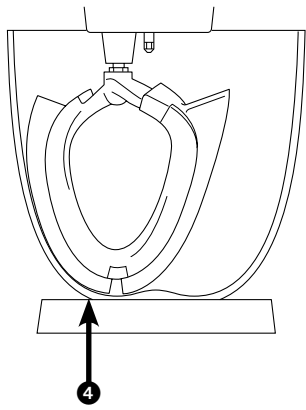
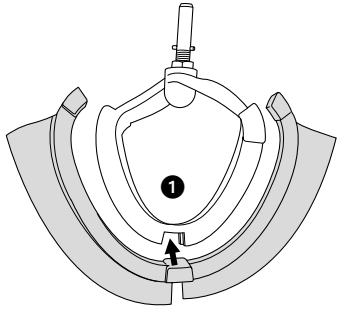

AX500 for use on KMix  
(TYPE KMX50, KMX50/  
KMX60/KMX80/KMX90  
series)

AT501 for use on  
Kitchen Machine Chef

AT502 for use on  
Kitchen Machine Major/  
Chef XL and Cooking  
Chef

The flexible beater is designed for creaming and mixing soft ingredients. It is not to be used with heavy recipes such as dough or hard ingredients, for example those containing fruit stones, bones or shells.

- 1 Carefully fit the flexible wiper blade onto the tool by locating the base of the wiper blade into the slot **1**, then feed one side into the groove before gently hooking the end in place **2**. Repeat with the other side **3**.
- 2 With the mixer switched off, insert the flexible beater and lower the mixer head. Check the position of the beater in the bowl **4**. Ideally it should be in contact with the bowl surface so that it gently wipes the bowl during mixing.
- 3 If the clearance needs to be adjusted, raise the mixer head and remove the beater.

- 4 Using the spanner provided loosen the nut sufficiently to allow adjustment of the shaft **5**. To lower the beater closer to the bottom of the bowl, turn the beater shaft anti-clockwise. To raise the beater away from the bottom of the bowl turn the shaft clockwise.
- 5 Tighten the nut.
- 6 Fit the beater to the mixer and lower the mixer head. Check its position (see point 2). Repeat the above steps as necessary until the beater is set correctly. Once this is achieved tighten the nut securely.  
Note: Some models are supplied with 2 different coloured wiper blades.

### care and cleaning

- 1 Always remove the flexible wiper blade from the tool before cleaning **6**.
- 2 Wash the flexible wiper blade and tool in hot soapy water, then dry thoroughly. Alternatively the parts can be washed in a dishwasher.  
Note: Please inspect the condition of the tool body before and after use and also regularly inspect the condition of the wiper blade and replace it if there are any signs of wear.

# service and customer care

## **UK only**

If you need help with:

- using your attachment
- servicing or repairs (in or out of guarantee)

☎ call Kenwood customer care on

**0345 222 0458. Have your model number (e.g. AX500, AT501 or AT502) and date code (e.g. 18B08) ready.** They are on the attachment outer carton.

## ● **spares and attachments**

☎ call 0844 557 3653.

## **other countries**

- If you experience any problems with the operation of your attachment, before requesting assistance visit [www.kenwoodworld.com](http://www.kenwoodworld.com).
- Please note that your product is covered by a warranty, which complies with all legal provisions concerning any existing warranty and consumer rights in the country where the product was purchased.
- If your Kenwood product malfunctions or you find any defects, please send it or bring it to an authorised KENWOOD Service Centre. To find up to date details of your nearest authorised KENWOOD Service centre visit [www.kenwoodworld.com](http://www.kenwoodworld.com) or the website specific to your Country.
- Designed and engineered by Kenwood in the UK.
- Made in China.